

Soils Map

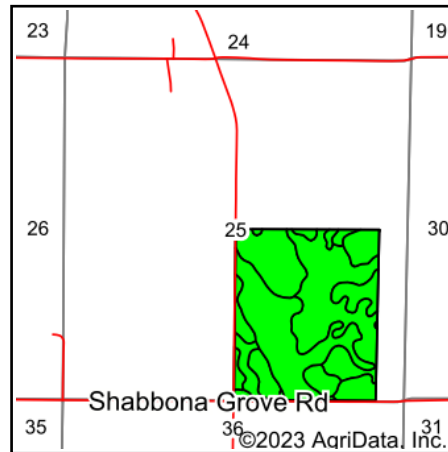

State: **Illinois**
 County: **DeKalb**
 Location: **25-38N-5E**
 Township: **Squaw Grove**
 Acres: **134**
 Date: **1/9/2023**

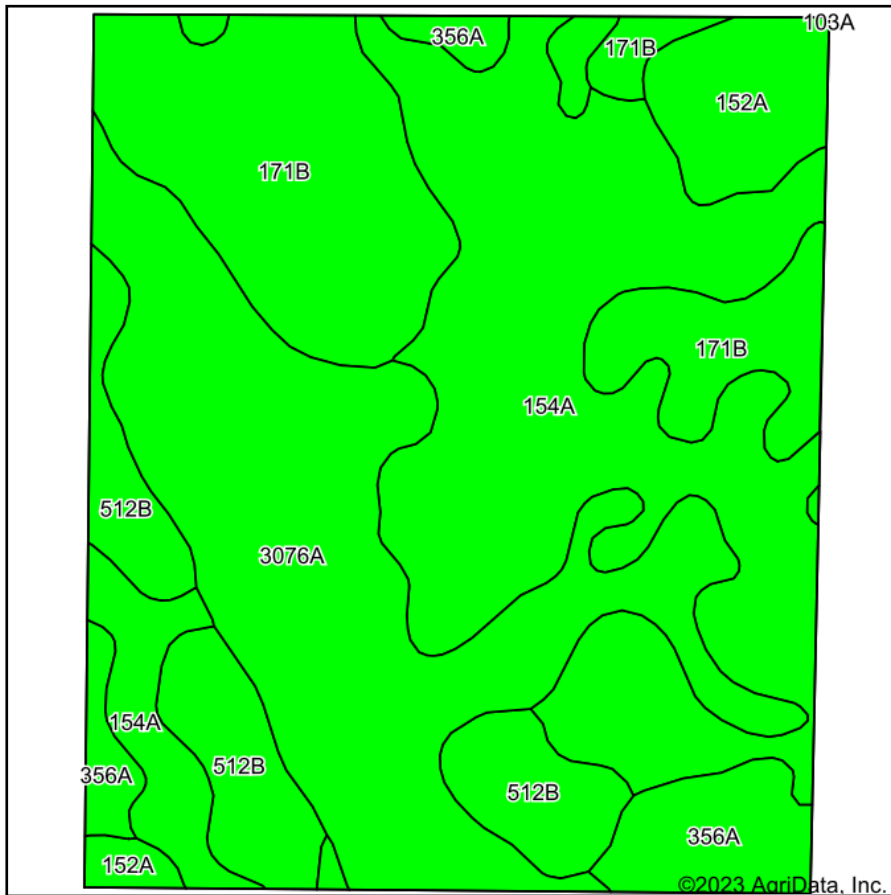

Soils data provided by USDA and NRCS.

Area Symbol: IL037, Soil Area Version: 17

Code	Soil Description	Acres	Percent of field	II. State Productivity Index Legend	Soil Drainage	Corn Bu/A	Soybeans Bu/A	Crop productivity index for optimum management
154A	Flanagan silt loam, 0 to 2 percent slopes	46.60	34.8%		Somewhat poorly drained	194	63	144
3076A	Otter silt loam, 0 to 2 percent slopes, frequently flooded	35.55	26.5%		Poorly drained	186	61	139
**171B	Catlin silt loam, 2 to 5 percent slopes	24.78	18.5%		Moderately well drained	**185	**58	**137
**512B	Danabrook silt loam, 2 to 5 percent slopes	12.41	9.3%		Moderately well drained	**185	**58	**137
152A	Drummer silty clay loam, 0 to 2 percent slopes	7.36	5.5%		Poorly drained	195	63	144
356A	Elpaso silty clay loam, 0 to 2 percent slopes	7.30	5.4%		Poorly drained	195	63	144
Weighted Average						189.5	61.1	140.7

Table: Optimum Crop Productivity Ratings for Illinois Soil by K.R. Olson and J.M. Lang, Office of Research, ACES, University of Illinois at Champaign-Urbana. Version: 1/2/2012 Amended Table S2 B811

Crop yields and productivity indices for optimum management (B811) are maintained at the following NRES web site: <http://soilproductivity.nres.illinois.edu/>

** Indexes adjusted for slope and erosion according to Bulletin 811 Table S3

Soils data provided by USDA and NRCS. Soils data provided by University of Illinois at Champaign-Urbana.