

# Soils Map

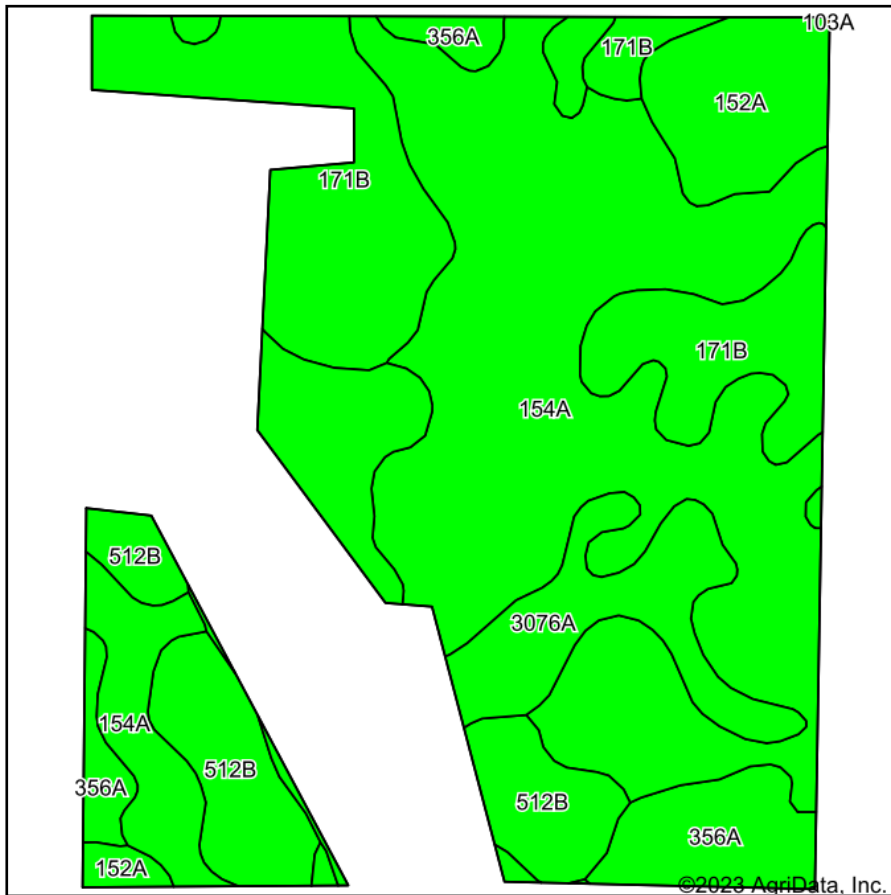

Soils data provided by USDA and NRCS.

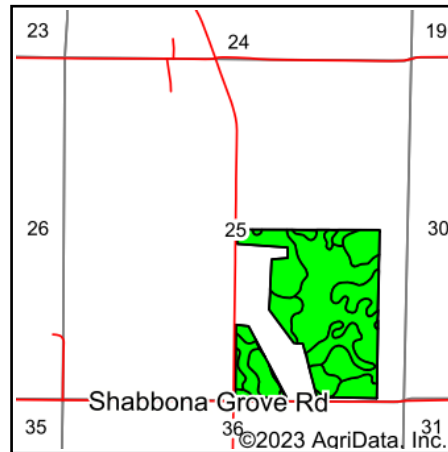

State: **Illinois**  
 County: **DeKalb**  
 Location: **25-38N-5E**  
 Township: **Squaw Grove**  
 Acres: **100.14**  
 Date: **1/9/2023**

Maps Provided By:  
  
 CUSTOMIZED ONLINE MAPPING  
 © AgriData, Inc. 2021 www.AgriDataInc.com



Area Symbol: IL037, Soil Area Version: 17

Code	Soil Description	Acres	Percent of field	Il. State Productivity Index Legend	Soil Drainage	Corn Bu/A	Soybeans Bu/A	Crop productivity index for optimum management
154A	Flanagan silt loam, 0 to 2 percent slopes	46.19	46.1%		Somewhat poorly drained	194	63	144
**171B	Catlin silt loam, 2 to 5 percent slopes	18.95	18.9%		Moderately well drained	**185	**58	**137
3076A	Otter silt loam, 0 to 2 percent slopes, frequently flooded	11.84	11.8%		Poorly drained	186	61	139
**512B	Danabrook silt loam, 2 to 5 percent slopes	9.59	9.6%		Moderately well drained	**185	**58	**137
152A	Drummer silty clay loam, 0 to 2 percent slopes	7.14	7.1%		Poorly drained	195	63	144
356A	Elpaso silty clay loam, 0 to 2 percent slopes	6.43	6.4%		Poorly drained	195	63	144
<b>Weighted Average</b>						<b>190.6</b>	<b>61.3</b>	<b>141.4</b>

**Table: Optimum Crop Productivity Ratings for Illinois Soil by K.R. Olson and J.M. Lang, Office of Research, ACES, University of Illinois at Champaign-Urbana.** Version: 1/2/2012 Amended Table S2 B811

Crop yields and productivity indices for optimum management (B811) are maintained at the following NRES web site: <http://soilproductivity.nres.illinois.edu/>

\*\* Indexes adjusted for slope and erosion according to Bulletin 811 Table S3

Soils data provided by USDA and NRCS. Soils data provided by University of Illinois at Champaign-Urbana.